

版次	日期	内 容

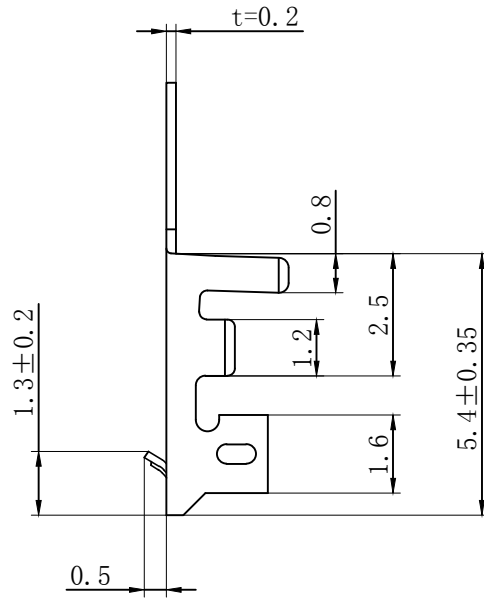

Electrical properties

- 1、Current rating: 2A AC\DC
- 2、Voltage rating: 100V AC\DC
- 3、Temperature range: -25°C to 85°C
- 4、Contact resistance: Initial value/20mΩ max
- 5、Insulation resistance: 1000MΩ min
- 6、Withstanding voltage: 800V AC/ minute
- 7、Applicable wire: AWG #24 to #30
- 8、Material : Phosphor bronze/Tin-plated
- 9、Qty/Reel: 10,000 PCS.
- 10、Thickness: 0.2 mm.

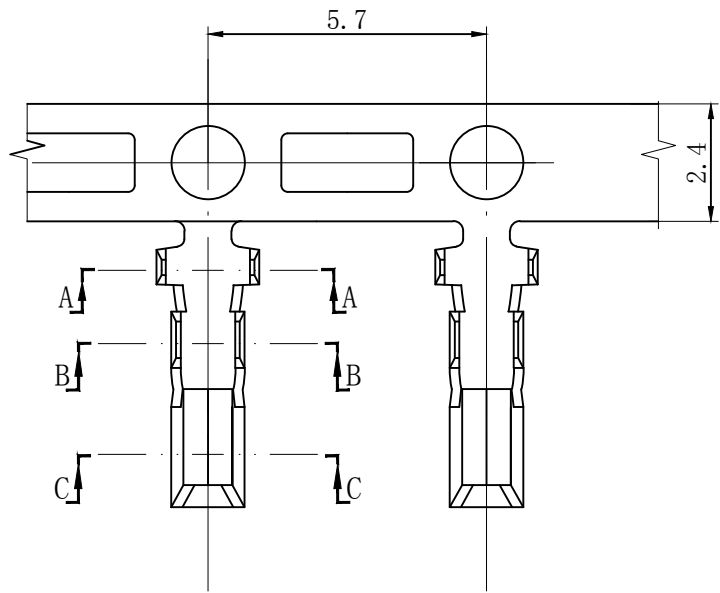
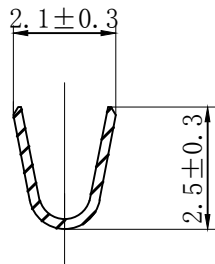

SECTION A-A

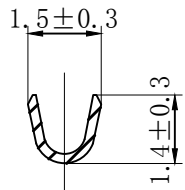

SECTION B-B

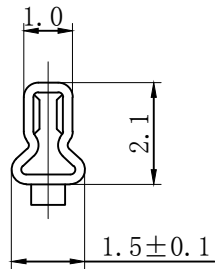

SECTION C-C

浙江乐马电气有限公司			设计	张书晨	
尺寸公差	角度公差	品名: PH-T	审核	王佳	
.X ±0.25	X.° ±3.0°				
.XX ±0.15	.X° ±2.0°		批 准	陈其林	
.XXX ±0.05	.XX° ±1.0°				
		单位: mm	比例: --	页数: 1/1	版本: A

图号: 20001-T	图号: 20001-T
比例: --	比例: --